

# MCR SERIES

## ELECTRIC COUNTER

### DESCRIPTION

The MCR Series is a robust medium sized electric totalizer designed for general counting purposes. Available in 4,5 and 6 digit models with different mounting options. Suitable for business machines, amusement and coin operated equipment, textile machinery, printing presses, machine tools, etc.

### MODEL SELECTION

TYPE	MODELS	DIGITS	MOUNTING	WEIGHT
Additive Total Counter	MCR - 4PN	4	Panel (Screw Type)	260 grams
	MCR - 5PN	5		260 grams
	MCR - 6PN	6		265 grams
	<del>MCR - 5X</del>	<del>5</del>	<del>Panel (Clamp)</del>	<del>320 grams</del>
	<del>MCR - 6X</del>	<del>6</del>		<del>320 grams</del>
	MCR - 4CN	4	Base (horizontal)	275 grams
	MCR - 5CN	5		275 grams
	MCR - 6CN	6		280 grams

→ Discontinued

### SPECIFICATIONS

Power Source	AC100V, 200V 50/60 Hz convertible / DC24V
Voltage Fluctuation	±10%
Power Consumption	AC : 4 - 5VA ; DC : 5W
Continuous Energizing	permissible
Counting Method	One pulse - One count (energizing - ½ count, unenergized - ½ count )
Counting Speed	15 Hz (maximum)
Pulse Width	33msec. minimum
Make (Duty)	1 : 1
Display	4 & 5 Digits: 5.4 x 3.8mm / 6 Digits: 5.4 x 2.8mm (white on black background)
Reset Time	Manual (push button)
Connection	PN Type : Soldering Terminal (Lead wires with terminal (260mm) are included) CN Type : Lead wire (AWG22)
Operating Temperature	-5°C - +40°C (non-freezing)
Operating Humidity	85%RH maximum (non-condensing)
Test Voltage	AC1,500V for 1 minute
Insulation Resistance	50MΩ minimum (500VDC megger)
Vibration	Endurance : 16.7 Hz, Width, double amplitude 4mm Malfunction : 10 - 55 Hz, double amplitude 0.5mm
Shock	Endurance : 300 m/s <sup>2</sup> (30G) / Malfunction : 50 m/s <sup>2</sup> (5G)
Construction	PN & CN : Plastic (Black) / X : Plastic (Gray)

### DIMENSIONS

MCR - 4PN • 5PN • 6PN

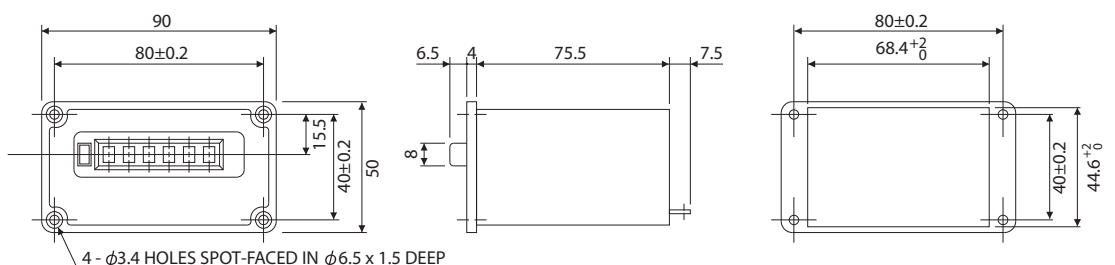

## DIMENSIONS

~~MCR-5X-6X~~  
Discontinued

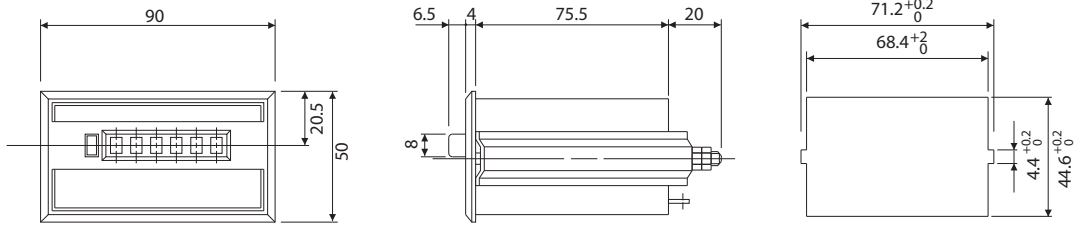

MCR-4CN-5CN-6CN

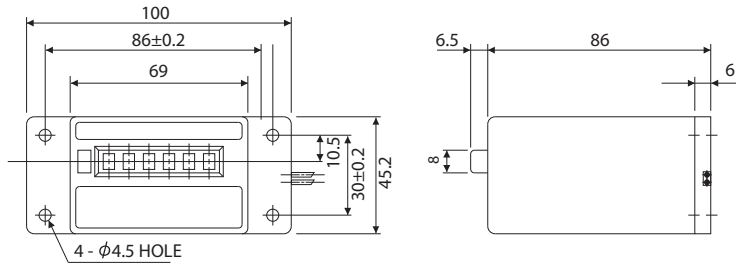

This catalog was last revised May 30, 2018.  
\*Subject to change without prior notice.  
All Rights Reserved, Copyright © 2018, LINE SEIKI CO., LTD.



**LINE SEIKI CO., LTD.**

Address : 37-7, Chuo-Cho, 2-Chome, Meguro-ku  
Tokyo 152-0001 JAPAN  
Contacts : Tel: +81-3-3716-5151 Fax: +81-3-3710-4552  
E-mail: webtrade@line.co.jp  
URL : <http://lineseiki.com/>